

**K<sub>S4.3</sub> T****M20****0.1 - 4 mmol/L K<sub>S4.3</sub>****S:4.3****Acid / Indicator**

## Instrument specific information

The test can be performed on the following devices. In addition, the required cuvette and the absorption range of the photometer are indicated.

Instrument Type	Cuvette	$\lambda$	Measuring Range
MD 200, MD 600, MD 610, MD 640, MultiDirect, PM 620, PM 630	ø 24 mm	610 nm	0.1 - 4 mmol/L K <sub>S4.3</sub>
SpectroDirect, XD 7000, XD 7500	ø 24 mm	615 nm	0.1 - 4 mmol/L K <sub>S4.3</sub>

## Material

Required material (partly optional):

Reagents	Packaging Unit	Part Number
Alka-M-Photometer	Tablet / 100	513210BT
Alka-M-Photometer	Tablet / 250	513211BT

## Application List

- Waste Water Treatment
- Drinking Water Treatment
- Raw Water Treatment

## Notes

1. The terms Alkalinity-m, m-Value, total alkalinity and Acid demand to K<sub>S4.3</sub> are identical.
2. For accurate results, exactly 10 ml of water sample must be used for the test.





## Determination of Acid capacity $K_{S4,3}$ with Tablet

Select the method on the device.

For this method, a ZERO measurement does not have to be carried out every time on the following devices: XD 7000, XD 7500



Fill 24 mm vial with **10 mL sample**.

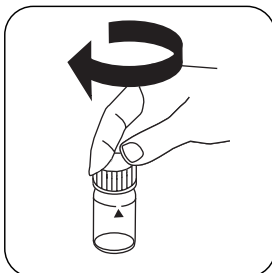

Close vial(s).

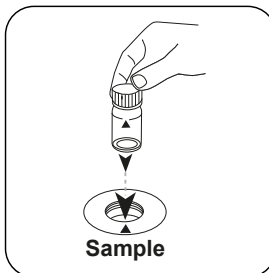

Place **sample vial** in the sample chamber. Pay attention to the positioning.

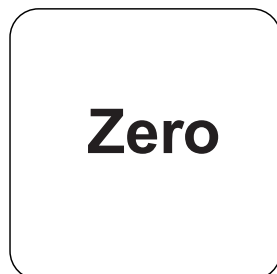

Press the **ZERO** button.

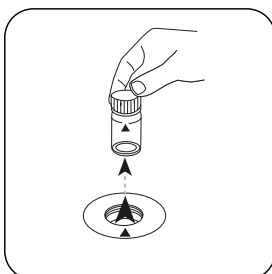

Remove the vial from the sample chamber.

For devices that require **no ZERO measurement**, start here.

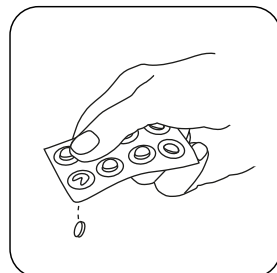

Add **ALKA-M-PHOTOMETER** tablet.

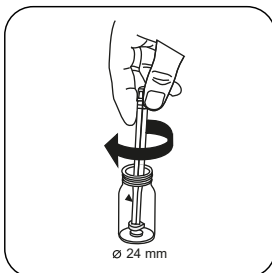

Crush tablet(s) by rotating slightly.

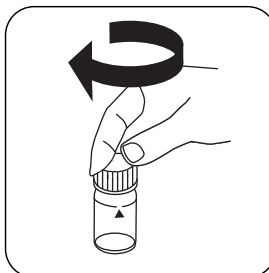

Close vial(s).

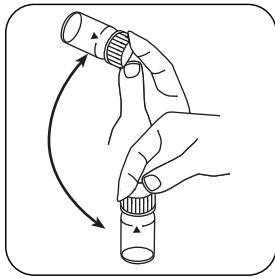

Dissolve tablet(s) by inverting.

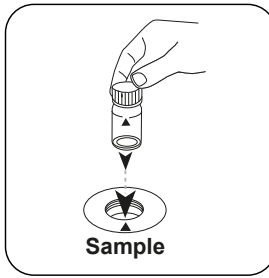

Place **sample vial** in the sample chamber. Pay attention to the positioning.

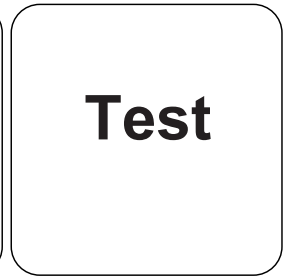

Press the **TEST** (XD: **START**) button.

The result in Acid Capacity  $K_{S4.3}$  appears on the display.



## Chemical Method

Acid / Indicator

## Appendix

### Calibration function for 3rd-party photometers

$$\text{Conc.} = a + b \cdot \text{Abs} + c \cdot \text{Abs}^2 + d \cdot \text{Abs}^3 + e \cdot \text{Abs}^4 + f \cdot \text{Abs}^5$$

	∅ 24 mm	□ 10 mm
a	$-6.4527 \cdot 10^{-1}$	$-6.4527 \cdot 10^{-1}$
b	$6.15265 \cdot 10^{+0}$	$1.32282 \cdot 10^{+1}$
c	$-4.02416 \cdot 10^{+0}$	$-1.86017 \cdot 10^{-1}$
d	$1.42949 \cdot 10^{+0}$	$1.42068 \cdot 10^{+1}$
e		
f		

#### Derived from

DIN 38409 - H 7-2