



Hardness total T

M200

2 - 50 mg/L CaCO₃

tH1

Metallphthaleine

Instrument specific information

The test can be performed on the following devices. In addition, the required cuvette and the absorption range of the photometer are indicated.

Instrument Type	Cuvette	λ	Measuring Range
MD 100, MD 600, MD 610, MD 640, MultiDirect, PM 620, PM 630	ø 24 mm	560 nm	2 - 50 mg/L CaCO ₃
SpectroDirect, XD 7000, XD 7500	ø 24 mm	571 nm	2 - 50 mg/L CaCO ₃

Material

Required material (partly optional):

Reagents	Packaging Unit	Part Number
Hardcheck P	Tablet / 100	515660BT
Hardcheck P	Tablet / 250	515661BT

Application List

- Cooling Water
- Boiler Water
- Drinking Water Treatment
- Raw Water Treatment

Preparation

1. Strong alkaline or acidic water samples should be adjusted between pH 4 and pH 10 before the analysis (use 1 mol/l Sulphuric acid or 1 mol/l Sodium hydroxide).





Determination of Hardness, Total with Tablet

Select the method on the device.

For this method, a ZERO measurement does not have to be carried out every time on the following devices: XD 7000, XD 7500



Fill 24 mm vial with **10 mL sample**.

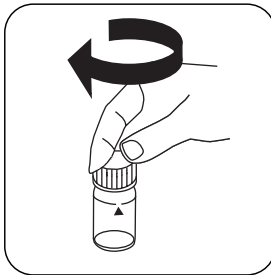

Close vial(s).



Place **sample vial** in the sample chamber. Pay attention to the positioning.

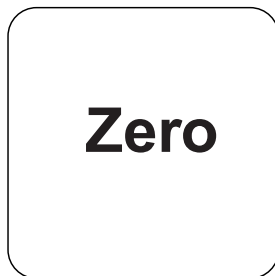

Press the **ZERO** button.

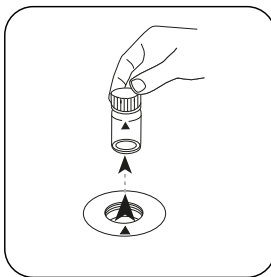

Remove the vial from the sample chamber.

For devices that require **no ZERO measurement**, start here.

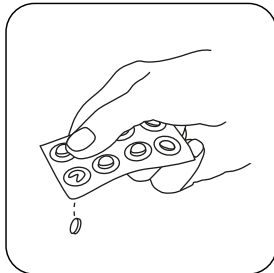

Add **HARDCHECK P tablet**.

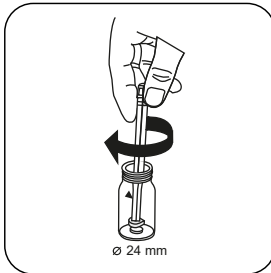

Crush tablet(s) by rotating slightly.

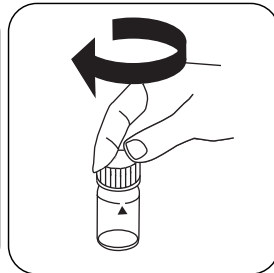

Close vial(s).



Dissolve tablet(s) by inverting.

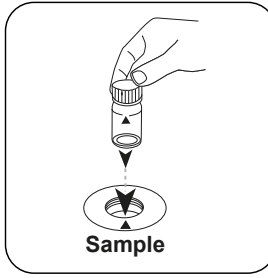

Place **sample vial** in the sample chamber. Pay attention to the positioning.



Press the **TEST** (XD: **START**) button.

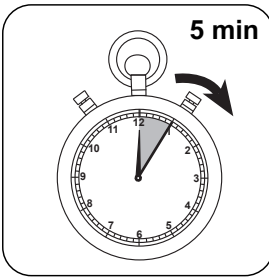

Wait for **5 minute(s) reaction time**.

Once the reaction period is finished, the measurement takes place automatically. The result in total Hardness appears on the display.



Analyses

The following table identifies the output values can be converted into other citation forms.

Unit	Cite form	Scale Factor
mg/l	CaCO ₃	1
	°dH	0.056
	°eH	0.07
	°fH	0.1
mg/l	°aH	1
	Ca	0.40043

Chemical Method

Metallphthaleine

Appendix

Calibration function for 3rd-party photometers

$$\text{Conc.} = a + b \cdot \text{Abs} + c \cdot \text{Abs}^2 + d \cdot \text{Abs}^3 + e \cdot \text{Abs}^4 + f \cdot \text{Abs}^5$$

	∅ 24 mm	□ 10 mm
a	$-4.33652 \cdot 10^0$	$-4.54265 \cdot 10^0$
b	$5.47914 \cdot 10^1$	$1.18846 \cdot 10^2$
c	$-8.96251 \cdot 10^0$	$-4.18717 \cdot 10^1$
d		
e		
f		

Interferences

Removeable Interferences

1. Interference from zinc and magnesium can be eliminated by the addition of 8-hydroxyquinoline.
2. Concentrations of strontium and barium that occur in waters and soils do not interfere.



Method Validation

Limit of Detection	0.88 mg/L
Limit of Quantification	2.64 mg/L
End of Measuring Range	50 mg/L
Sensitivity	42.5 mg/L / Abs
Confidence Intervall	2.62 mg/L
Standard Deviation	1.08 mg/L
Variation Coefficient	4.17 %

Bibliography

Photometrische Analyseverfahren, Schwedt, Wissenschaftliche Verlagsgesellschaft mbH, Stuttgart 1989